

Binder for Tube Tube Binder

● *Bind a plurality of Tubes by Clamping it.*

● *Fixable on Wall with Fixing Holes.
Fixing hole is removable when unnecessary.*

Open / Close in a single operation

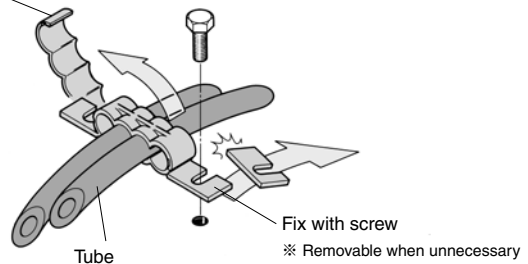

Model Designation (Example)

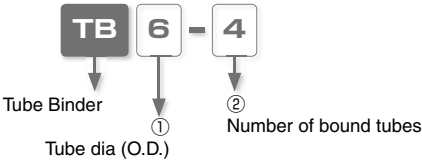

① Tube dia (O.D.)

Code	4	6	8	10	12
O.D. (mm)	ø4	ø6	ø8	ø10	ø12

② Number of bound tubes

Code	2	3	4
Number of tubes	2	3	4

△ Detailed Safety Instructions

Before using PISCO products, be sure to read "Safety Instructions" and "Safety Instruction Manual" on page 23 to 27 and "Common Safety Instructions for Tubes" on page 593 to 594.

■ Applicable Tube

PISCO Tubes

- Tube for General Piping···Polyurethane Tube (P.596), Nylon Tube (P.608), Vacuum Tube (P.612)
- Tube for Special Environments···Fluororesin (PFA) Tube (P.628), Polyamide Tube (P.634), Anti-spatter Tube (P.646), Anti-Static Tube (P.650), Fluororesin (PFA) Tube Clean-Room Package (P.638), Polyurethane Tube Clean-Room Package (P.642)

TUBE

MAKE-TO-ORDER
PRODUCTS

656

Tube
Binder

Tube
cutter

Insert
Ring

Tube
Reel

TB Tube Binder

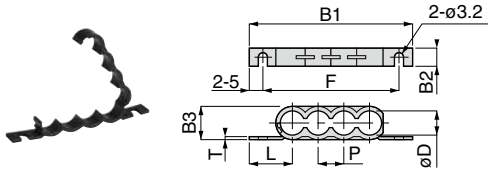

Unit : mm

Model code	Applicable Tube O.D. øD	B1	B2	B3	L	P	F	T	Weight (g)
TB4-2	4	29.1	6	6.5	12.5	4.1	19.1	1.2	0.24
TB4-3		33.2				2-4.1	23.2		0.32
TB4-4		37.3				3-4.1	27.3		0.37
TB6-2	6	34.1	6	8.5	14	6.1	24.1	1.2	0.35
TB6-3		40.2				2-6.1	30.2		0.45
TB6-4		46.3				3-6.1	36.3		0.54
TB8-2	8	38.1	6	10.9	15	8.1	28.1	1.4	0.47
TB8-3		46.2				2-8.1	36.2		0.65
TB8-4		54.3				3-8.1	44.3		0.78
TB10-2	10	44.1	8	13.3	17	10.1	34.1	1.6	0.87
TB10-4		64.3				3-10.1	54.3		1.52
TB12-2	12	48.1	8	15.5	18	12.1	38.1	1.7	1.08
TB12-4		72.3				3-12.1	62.3		2.91

※ Material of Binder is PA or PP.



Protection Ring from Tube Deformation Insert Ring

TUBE

MAKE-TO-ORDER
PRODUCTS

668

- *Protect tubes from deformation.*
- *Ultra soft tube is connectable to Fitting.*
- *Necessary for the connection with Push-In Fitting, when fluid medium is water.*

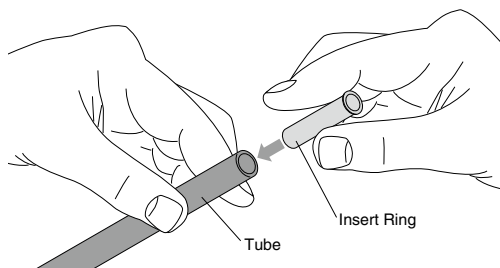

Insert
Ring

Tube
Reel

Insert Ring

Model Designation (Example)

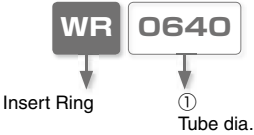

① Tube dia.

Code	0425	0640	0850	0860	1065	1075	1280	1290	1613
Tube O.D. (mm)	ø4	ø6	ø8	ø8	ø10	ø10	ø12	ø12	ø16
Tube I.D. (mm)	ø2.5	ø4	ø5	ø6	ø6.5	ø7.5	ø8	ø9	ø13

△ Detailed Safety Instructions

Before using PISCO products, be sure to read "Safety Instructions" and "Safety Instruction Manual" on page 23 to 27 and "Common Safety Instructions for Tubes" on page 593 to 594.

Caution

1. There is a possibility of dropping-off of Insert Ring from a tube edge into the piping, depending on the combination with Tubes. Implement specific countermeasures in advance, for the case that it flows down into pipes and cause a problem.

■ Applicable Tube and Related Products

PISCO's Push-In Fittings and Tubes

TUBE

MAKE-TO-ORDER
PRODUCTS

670

Insert
Ring

Tube
Reel

WR

Insert Ring

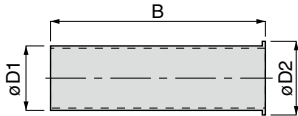

Unit : mm

Model code	Tube O.D. x I.D.(ø)	øD1	øD2	B	Thickness	Weight (g)
WR 0425	4 × 2.5	2.5	3	18	0.2	0.2
WR 0640	6 × 4	4	4.5	18.5	0.2	0.35
WR 0850	8 × 5	5	5.5	20	0.2	0.45
WR 0860	8 × 6	6	6.5	20	0.2	0.6
WR 1065	10 × 6.5	6.5	7	22	0.2	0.7
WR 1075	10 × 7.5	7.5	8	22	0.2	0.8
WR 1280	12 × 8	8	8.5	25	0.2	0.9
WR 1290	12 × 9	9	9.5	25	0.2	1.15
WR 1613	16 × 13	13	13.5	27	0.2	1.9

※ Material of Insert Ring is SUS304.

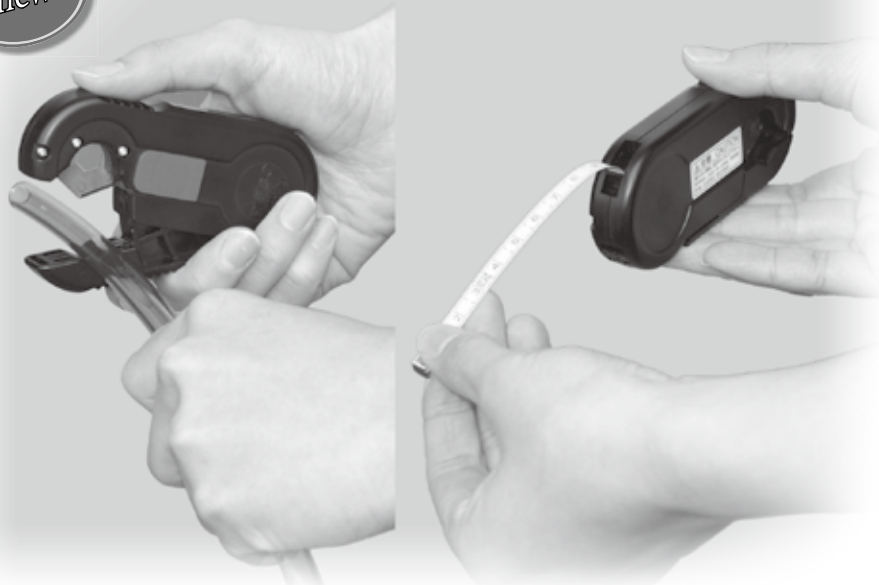

Tube Cutter with Measuring tape built-in Tube Cutter

- *Cut Tubes to Required Length, using Measuring tape.*
(Measuring tape length: 1 m)
- *Mountain-shaped Double Blade. Rotate it for New Blade Side.*
- *Nicely and Surely Cut Tube with Tube Guide.*
- *Safety Lock Function.*

Tube Cutter

FITTING

CONTROLLER

VALVE

TUBE

Model Code of Tube Cutter (Example)

TC-21

Tube Cutter

Model Code of Tube Cutter Blade (Example)

TC-C

Replacement Blade

659

Standard Tube

Multi-core Tube

Coiling Tube

Twin Coiling Tube

Purposen / Polyamide Tube

Clean Room Tube

Anti-Spatter Tube

Anti-Static Tube

Tube Binder

Tube cutter

Operating procedure and Parts names

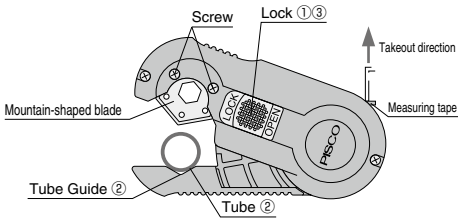

- ① Unlock the safety lock by sliding it to "Open" side.
- ② Place a tube on Tube Guide and cut it.
- ③ Lock the safety lock by sliding it to "Lock" side.

△ Detailed Safety Instructions

Before using PISCO products, be sure to read "Safety Instructions" and "Safety Instruction Manual" on page 23 to 27 and "Common Safety Instructions for Tubes" on page 593 to 594.

Warning

1. Do not touch the blade to avoid personal injury.
2. Tighten the screws properly after replacing blade. There is a possibility of getting hurt from the fallen blade due to the loosened screws.

Caution

1. Lock the safety lock when Tube Cutter is not in use. Do not carry it in a pocket. Safety lock can be unlocked unexpectedly by shakings or impacts.
2. Tube Cutter can be used for PISCO Tubes only. Do not use it for cutting an electric wire or a steel pipe.

■ Applicable Tube

General PISCO Tubes

- Tube for General Piping···Polyurethane Tube (P.596), Nylon Tube (P.608), Vacuum Tube (P.612)
- Tube for Special Environments···Fluororesin (PFA) Tube (P.628), Polyamide Tube (P.634), Anti-spatter Tube (P.646), Anti-Static Tube (P.650), Fluororesin (PFA) Tube Clean-Room Package (P.638), Polyurethane Tube Clean-Room Package (P.642)

TC-21 Tube Cutter

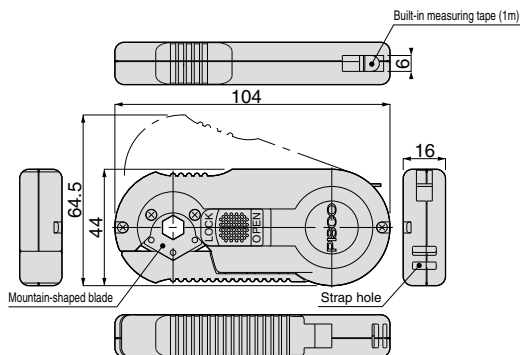

How to replace the blade

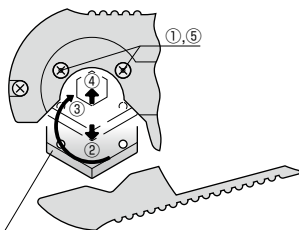

Mountain-shaped blade
(Replacement blade model code: TC-C)

- ① Loosen two screws after unlocking the safety lock.
- ② Take the blade out from the blade groove.
- ③ Rotate the blade by 180° to use other side of it.
- ④ Install it into the blade groove by holding the hexagonal hole of the blade.
- ⑤ Tighten the screws until the blade is fixed properly.
(Recommended tightening torque: 0.4Nm)

チューブストリッパカッタ

Cover Stripping Cutter for Antispatter Tube

Antispatter Tube Cover Peeler

11月初旬発売
Released in early
November 2014

- 弊社の耐スパッタ機器の挿入寸法に合わせて被覆を鉛筆を削る感覚でカット。
■ Peeling only the flame retardant cover like sharpening a pencil appropriate for the tube inserting length of Pisco's anti-spatter products.

■ 耐スパッタ機器一覧 / Anti-spatter products

ワンタッチ継手 / Push-in fitting		速度制御弁 / Speed controller		流量制御弁 / Flow controller
チューブフィッティングスパッタ Tube Fitting Spatter	チューブフィッティングブラス Tube Fitting Brass	スピードコントローラスパッタ Speed Controller Spatter	スピードコントローラブラス Speed Controller Brass	スロットルバルブブラス Throttle (Needle) Valve Brass

- インナーチューブにキズをつけません。
■ No damage to the inner tube.
- 透明カバーの採用により、カットの進行状況が一目で分かる。
■ The transparent cover enables to check cutting progress easily.

注文形式(例) / Model Designation (Example)

TSC

①

8

②

②. 適用チューブサイズ／Tube dia.

記 号 Code	4	6	8	10	12
チューブ外径 (mm) Dia.	ø4	ø6	ø8	ø10	ø12
適用チューブ形式 Applicable tube model	FB0425	FB0640	FB0860	FB1075	FB1290

①. チューブストリップカッター／Antispatter Tube Cover Peeler

①. チューブストリッパカッタ / Antispatter Tube Cover Peeler

掲載商品の注意事項／Detailed Safety Instruction

警告／Warnings

1. 刃が内蔵されています。樹脂部のひび・割れ・欠けなどの破損が見つかった場合は、ケガの危険性がありますので、直ちにご使用を止めてください。

2. 製品の基本構造や性能・機能にかかわる分解・改造は行わないでください。製品本体が破損し、ケガの原因となる危険性があります。

3. 製品に引張り、ねじり、曲げなどの負荷がかからないようにしてください。製品本体が破損し、ケガの原因となる危険性があります。
1. A blade is equipped inside. Please stop using this product immediately when a crack, a fracture, or a chipping is found on the resin part to prevent an injury.

2. Do not dismantle or remodel the product in ways which affect the basic structure, performance or function of the product. It may damage the product itself and cause an injury.

3. Avoid putting load on the product such as pulling, twisting, or bending. It may damage the product itself and cause an injury.

注意／Cautions

1. 弊社のスパッタチューブ専用カッターです。スパッタチューブの被覆カット以外でのご使用は止めてください。

2. ひどく曲がったチューブや潰れたチューブのご使用は、製品機能を十分に発揮できない可能性があります。

3. 排出口を塞いだ状態でカットしますとカットした被覆材が本体内に詰まりますので、ご注意ください。
1. This peeler is designated for PISCO Antispatter Tube (flame-retardant tube). Do not use it for other purposes except for peeling the cover of Antispatter Tube.

2. When using for an excessively bent or crushed tube, the product may not be able to deliver its performance.

3. If the peeler is used with the cover discharging spout closed, the stripped cover part may get clogged inside the peeler.

外観図／Outline Dimensional Drawing

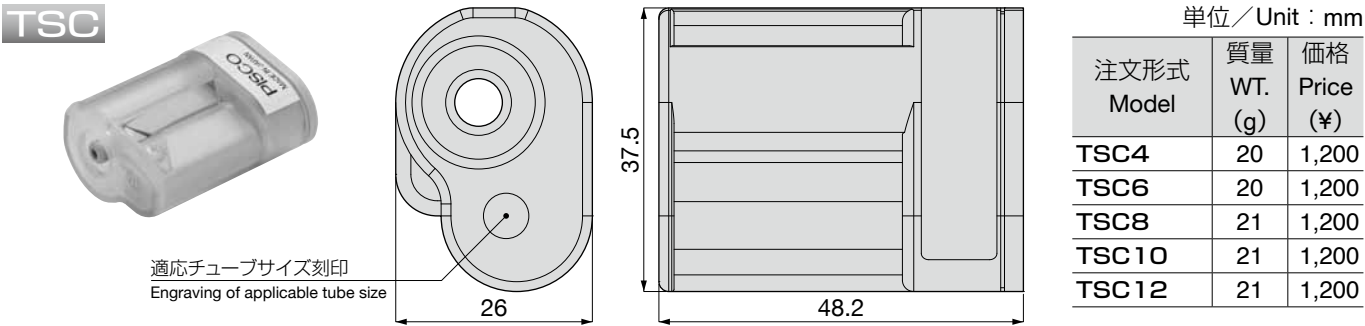

操作手順／How to use the Cutter

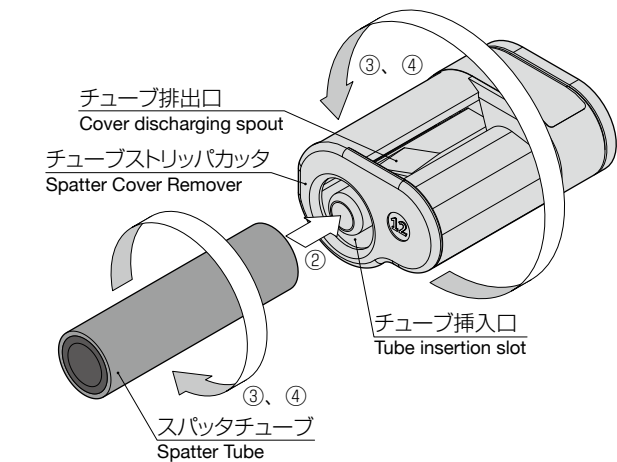

- ①スパッタチューブの切断面が直角になるように切断してください。

②スパッタチューブを挿入口から刃に当たるまで挿入してください。

③スパッタチューブ、またはチューブストリップカッタを時計方向に回転させながら、突き当たるところまで挿入してください。

④アウターチューブ（被覆）が完全に切り離されるまでスパッタチューブ、またはチューブストリップカッタを回転させ、スパッタチューブをチューブストリップカッタから抜いてください。
※スパッタチューブかチューブストリップカッタのどちらか回しやすい方を回転させてください。
- ①When cutting an antispatter tube, make sure to form the cut surface of the tube orthogonally.

②Inert an antispatter tube from tube insertion slot until it touches the blade.

③Insert the antispatter tube further with rotating the tube or the Antispatter Tube Cover Peeler clockwise until the tubing edge abuts against the end in the peeler.

④Keep rotating an antispatter tube or the cover peeler until the cover gets stripped completely, and then take out the tube from the Antispatter Tube Cover Peeler.
- * Rotate either the tube or the cover peeler which is easier to rotate.

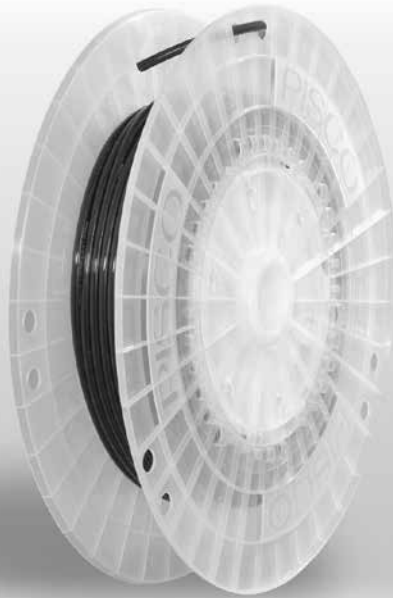

Reel for Tube Tube Reel

- *Easy to Supply and Change Tube.*
- *4 Width Selections according to Tube Sizes.*
- *Reusable Reel.*
 - The reel is reusable to reduce waste.
 - Material of the reel is all plastic.

■ **Model Designation (Example)**

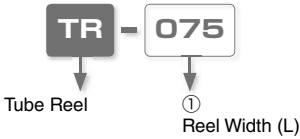

① **Reel Width (L)**

Code	075	100	160	200
L (mm)	75	100	160	200

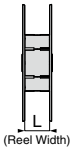

■ **Specifications**

Model code		TR-075	TR-100	TR-160	TR-200
Applicable Tube dia.	mm size	ø4, ø6mm	ø8mm	ø10mm	ø12, 16mm
	inch size	ø1/8, ø5/32, ø3/16, ø1/4	ø5/16	ø3/8	ø5/8, ø1/2
Operating temperature range		-10 ~ 50℃			

673

⚠ **Detailed Safety Instructions**

Before using PISCO products, be sure to read “Safety Instructions” and “Safety Instruction Manual” on page 23 to 27 and “Common Safety Instructions for Tubes” on page 593 to 594.

Warning

1. Do not wind up a heavy load other than tubes on Tube Reel. There is a possibility of falling down of the heavy load by damaging the reel.

Caution

1. Avoid using Tube Reel out of the operating temperature range (-10~50℃). Otherwise, there is a possibility of deforming, dismantling and damaging it.
2. Since Tube Reel is made of resin, it should be handled with care.
3. Tube Reel is specially designed for PISCO Tubes.

■ Applicable Tube and Related Products

Polyurethane Tube.....P.596

※ . Contact us for the other tubes

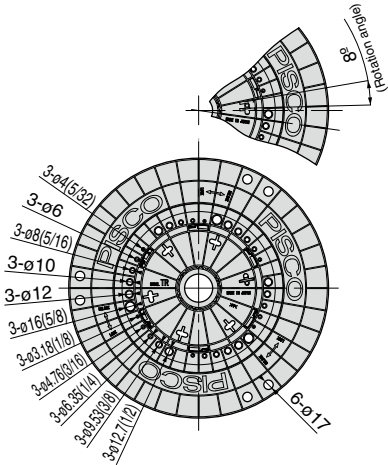
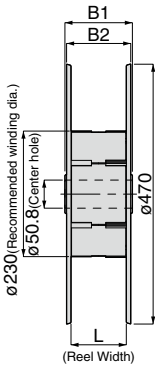

Unit : mm

Model code	L	B1	B2	Weight (g)
TR-075	75	97	91	1248
TR-100	100	122	116	1270
TR-160	160	182	176	1318
TR-200	200	222	216	1357

※. Tube shown in image is not included in the product.

Tube Reel Operation Manual

Please read this operation manual carefully so that the product can be used safely. Customers are requested to store this operation manual with great care.

⚠ Warning

- Don't load anything heavy other than tube on this product. Reel could be broken to allow the heavy object to drop.

⚠ Caution

- Don't use this product under any environment exceeding the range of operating temperature (-10 to 50°C). Product could be deformed, dismantled or broken.
- This product is made of resin, and should be handled with great care.
- Tube Reel is specially designed for PISCO Tubes.

Features

- It is very easy to reload/replace tubes.
- It contributes to environmental load reduction.
 - Reel can be used repeatedly, and the amount of waste material can be reduced.
- 4 types of reels are available in accordance with the tube diameter to be used. For the details, see the table below.

Tube diameter (mm)	Model code			
	TR-075	TR-100	TR-160	TR-200
ø4(5/32)	○			
ø6	○			
ø8(5/16)		○		
ø10			○	
ø12				○
ø16(5/8)				○
ø1/8	○			
ø3/16	○			
ø1/4	○			
ø3/8			○	
ø1/2				○

Detail configuration of components (per set)

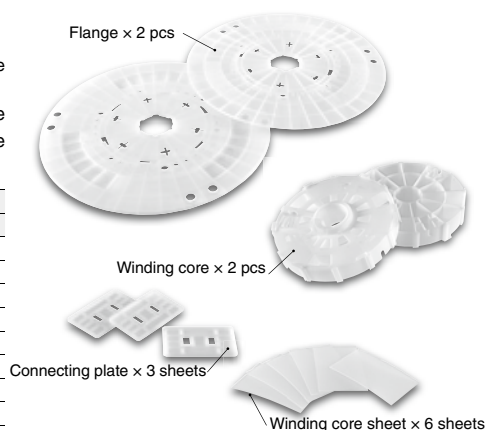

*1. Material: PP (polypropylene)

*2. The material might be changed due to our convenience.

How to assemble

- Insert both ends of connecting plate into the grooves (at 3 places) on the winding cores.

Note) Insert this firmly until it clicks. Clicking sound indicates that the unit is fixed.

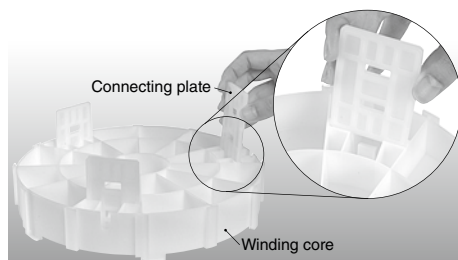

- Similar to (1), insert the other winding core along the groove into the connecting plate which has been set.

Note) Insert this firmly until it clicks. Clicking sound indicates that the unit is fixed.

- Be careful not to catch fingers between the parts.

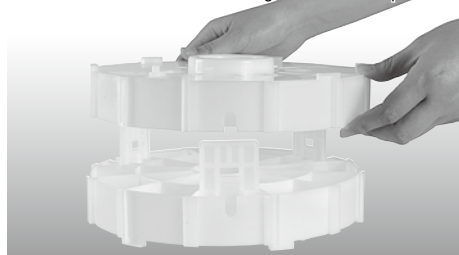

How to assemble

- (3) Loosen the winding core sheet, and fix it to the groove around the winding core (at 6 places).

Note) • Check if both ends of winding core are fixed firmly in the grooves of winding core.

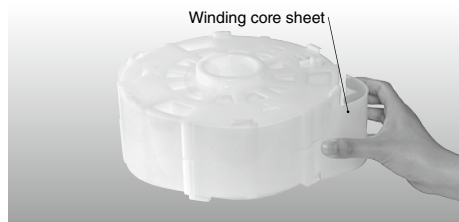

- (4) Fix the flange center hole into the convex part at center of winding core, and turn the flange counterclockwise.

Note) • Check if the logo PISCO is set on top.

- Check if the flange fixing claws (6 places) of winding core are fixed in the flange cutouts, and turn it in the counterclockwise.
- Turn until the flange clicks and is locked.

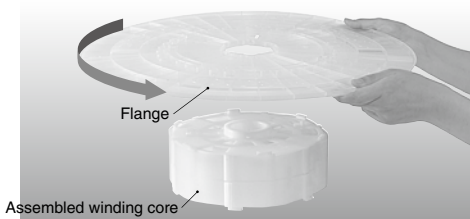

- (5) Load the tube, and make the inner tube terminal go through the insert hole of the flange to prevent the tube from idling.

Note) • Insert hole may indicate tube diameter. So insert the tube of corresponding tube diameter.
• Depending on tube binding shape, it might be necessary to load the tube by widening the inner binding diameter by hands.

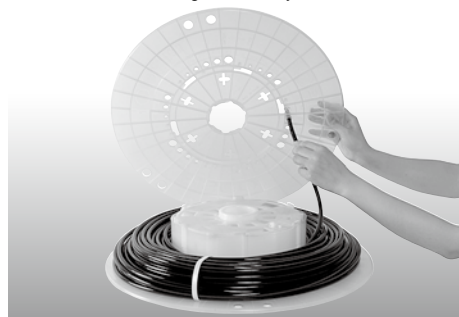

- (6) Similar to the step (4), turn the flange counterclockwise after setting the flange. When assembly is completed, cut tube-binding tapes at 2 places, and make the tube outer terminal go through the tube insert hole to fix the tube.

Note) • Turn until the flange clicks and is locked.

- Be careful not to damage the tube when cutting tube-binding tapes.

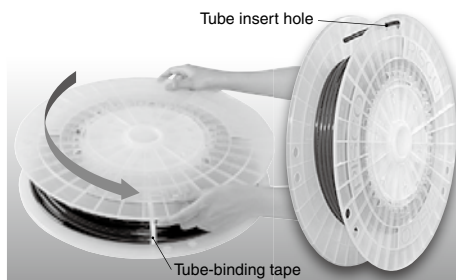

Reloading and replacing the tube

When reloading or replacing tubes, the flange can be unlocked by turning the flange in the clockwise while pressing the winding core button protruding from flange surface. Complete the reloading/replacement of tubes, thereafter, by the following procedures (5) to (6).

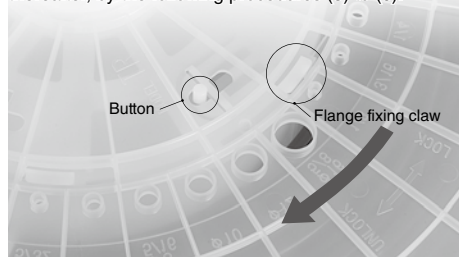

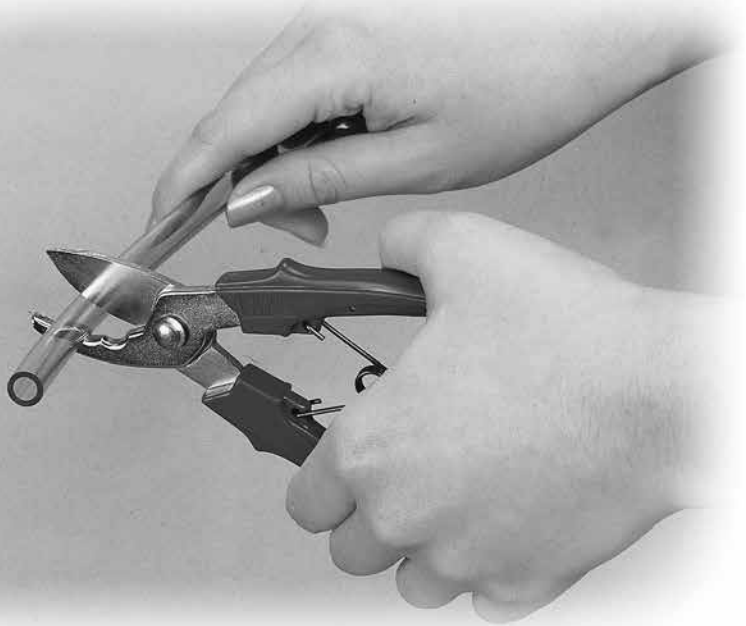

Tube Cut Nipper Tube Shears

● *Cut Tube Smoothly.*

● *Sharp Edge and Excellent in Durability.*

■ **Model Code of Tube Shears (Example)**

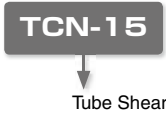

⚠ **Detailed Safety Instructions**

Before using PISCO products, be sure to read "Safety Instructions" and "Safety Instruction Manual" on page 23 to 27 and "Common Safety Instructions for Tubes" on page 593 to 594.

Caution

- 1. Lock the safety lock when Tube Shears is not in use. There is a possibility of getting hurt from released edge. Do not carry it in a pocket. Safety lock can be unlocked unexpectedly by shakings or impacts.
- 2. Tube Shears can be used for PISCO Tubes only. Do not use it for cutting an electric wire or a steel pipe.

■ **Applicable Tube**

General PISCO Tubes

- Tube for General Piping···Polyurethane Tube (P.596), Nylon Tube (P.608), Vacuum Tube (P.612)
- Tube for Special Environments···Fluororesin (PFA) Tube (P.628), Polyamide Tube (P.634), Anti-spatter Tube (P.646), Anti-Static Tube (P.650), Fluororesin (PFA) Tube Clean-Room Package (P.638), Polyurethane Tube Clean-Room Package (P.642)

663

- Standard Tube
- Multi-core Tube
- Coiling Tube
- Twin Coiling Tube
- Fluororesin / Polyamide Tube
- Clean Room Tube
- Anti-Spatter Tube
- Anti-Static Tube
- Tube Binder
- Tube cutter

TCN-15 Tube Shears

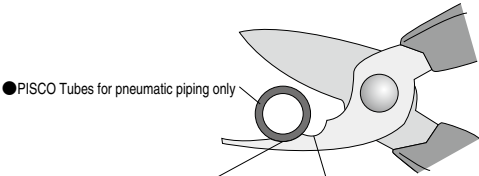

■ **Tube Guide (Large)**

mm size	ø10mm	ø12mm	ø16mm
inch size	ø3/8	ø1/2	ø5/8

■ **Tube Guide (Small)**

mm size	ø3mm	ø4mm	ø6mm	ø8mm	
inch size	ø1/8	ø5/32	ø3/16	ø1/4	ø5/16