

- > **Port size: 3/8" to 3/4"**
(PTF/ISO G)
- > **Excelon® Plus design**
allows in-line
installation or modular
installation with other
Excelon® Plus products
- > **Push to lock adjusting**
knob with built in
tamper resistant feature
- > **Easy to read flush**
mounted integrated
pressure gauge as
standard
- > **Standard relieving**
models allow reduction
of downstream pressure
when the system is
dead-ended



Technical features

Medium:

Compressed air only

Maximum supply pressure:

290 psi (20 bar)

Outlet pressure ranges:

4 to 145 psi (0.3 to 10 bar),

4 to 58 psi (0.3 to 4 bar),

10 to 247 psi (0.7 to 17 bar)

Gauge:

Integrated as standard

Gauge port 1/8" as option

Port size:

G3/8, G1/2, G3/4,

3/8 PTF, 1/2 PTF, 3/4 PTF

Diaphragm Type:

Relieving

Flow:

265 scfm (125 dm³/s)

at port size: 1/2",

inlet pressure 145 psi (10 bar),

91 psi (6.3 bar) set pressure and a

Δp: 14.5 psi (1 bar) droop from set.

Ambient/Media temperature:

-4 to +149°F (-20 to +65°C)

Air supply must be dry enough

to avoid ice formation at

temperatures below +35°F (+2°C).

Materials:

Body: Die cast aluminum

Body covers: ABS

Bonnet: POM/Aluminum

Valve: PP

Elastomers: NBR

Technical data R84G - standard models

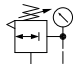
Symbol	Port PTF	Pressure range psi (bar)	Adjustment	Integrated gauge psi (bar)	Weight lb (kg)	Model*)
	3/8	5 to 145 (0.3 to 10)	Knob	0 to 145 (0 to 10)	1.30 (0.59)	R84G-3AK-RMG
	1/2	5 to 145 (0.3 to 10)	Knob	0 to 145 (0 to 10)	1.30 (0.59)	R84G-4AK-RMG
	3/4	5 to 145 (0.3 to 10)	Knob	0 to 145 (0 to 10)	1.30 (0.59)	R84G-6AK-RMG

*) All models shown here are supplied with integrated gauge applicable for flow direction left to right.

With flow direction right to left please use the online configurator www.imi-precision.com/air-preparation-configurator or contact IMI Norgren

Option selector *1)

Port size	Substitute
3/8"	3
1/2"	4
3/4"	6
Thread form	Substitute
PTF	A
ISO G parallel	G
Adjustment	Substitute
Knob	K
T-bar	T*2)

R84G-★-★-★-★-★-★

Gauge	Substitute
With (fitted integrated gauge)	G
Without integrated gauge but with gauge port 1/8"	N
Pressure range *3)	Substitute
4 to 58 psi (0.3 to 4 bar)	F
4 to 145 psi (0.3 to 10 bar)	M
10 to 247 psi (0.7 to 17 bar)	S*2)

*1) All models shown here are applicable for flow direction left to right. With flow direction right to left please use the online configurator www.imi-precision.com/air-preparation-configurator or contact IMI Norgren

*2) Units with 247 psi (17 bar) outlet pressure range are available only with the T-bar adjustment; therefore substitute T at the 7th position and S at the 9th position.
T-bar handle only available with 247 psi (17 bar) option.

*3) Outlet pressure can be adjusted to pressures in excess of, and less than, those specified. Do not use these units to control pressures outside of the specified ranges.

Flow characteristics

Port size: 1/2"
Inlet pressure: 101 psi (7 bar)

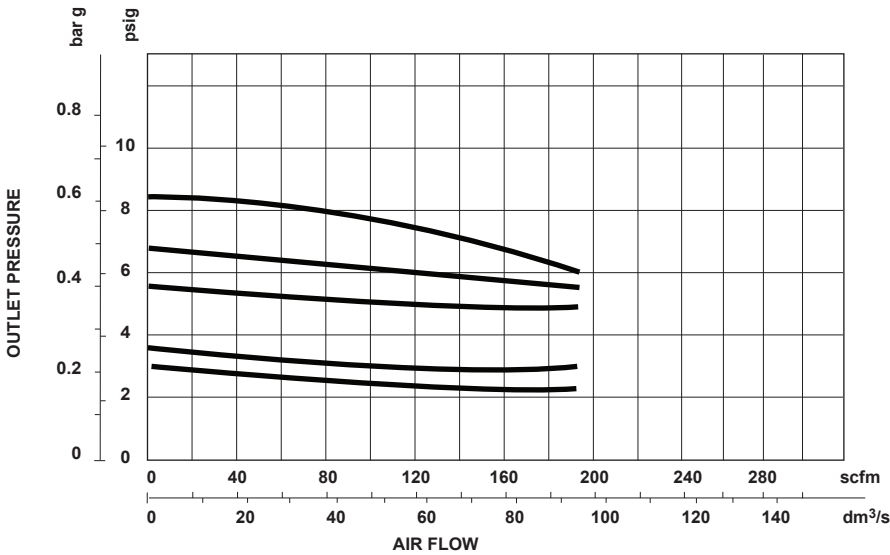



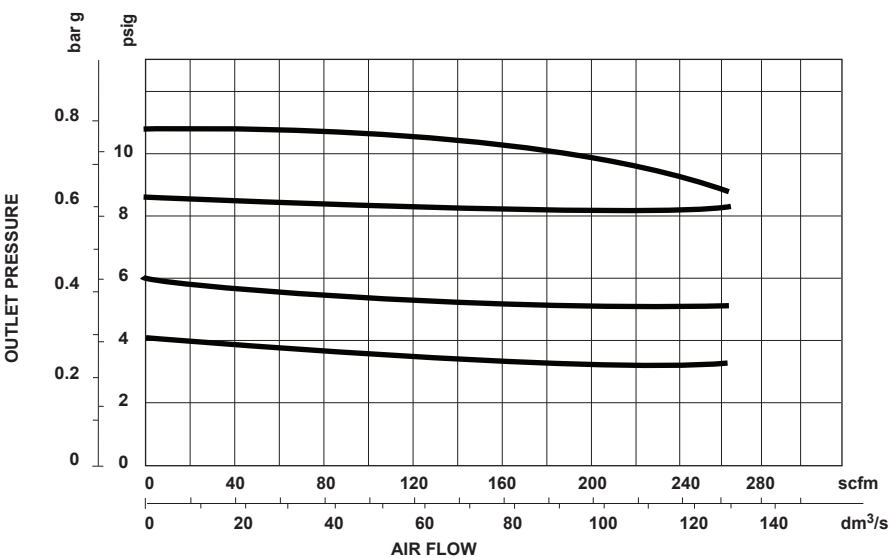





Port size: 1/2"
Inlet pressure: 145 psi (10 bar)









Accessories

Quikclamp®	Quikclamp® with bracket assembled	NECK mounting bracket & Panel nut	Panel mounting nut	Mounting bracket
				
Page 4	Page 4	Page 5	Page 5	Page 5
840014-51KIT	840014-52KIT	840068-51KIT	840048-89KIT	840024-50KIT

Integrated gauge 10 bar gauge	Integrated gauge 20 bar gauge	Gauge adaptor kit 1/8 PTF	Gauge adaptor kit R 1/8
			
840073-01KIT	840073-02KIT	840100-01KIT	840100-02KIT

Pressure sensing block 1/4 PTF	Pressure sensing block G1/4	Padlock	Lockout device
			
Page 5	Page 5		
840016-50KIT	840016-51KIT	840055-01KIT	840055-02KIT

Full flow porting block 3/4 PTF	Full flow porting block G3/4	Full flow porting block 3/4 PTF	Full flow porting block G3/4
			
Page 6	Page 6	Page 6	Page 6
840028-68KIT	840028-69KIT	840028-50KIT	840028-53KIT

Pressure switch interface block (18D pressure switch) G1/2	Pneumatic pressure switch 18D (7 to 120 psi)	Digital pressure switch 51D (-14.5 to 145 psi)
		
Page 7	Page 7	Page 7
0337717000000000	0881300000000000	0860811000000000

Port Adaptors

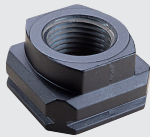

3/8 PTF	840015-02KIT
1/2 PTF	840015-03KIT
3/4 PTF	840015-04KIT
G3/8	840015-10KIT
G1/2	840015-11KIT
G3/4	840015-12KIT

Gauges (For regulators with gauge port instead of integrated gauge)

Center back connection, white face



Pressure range

(psi)	(bar) *3)	(MPa)	ø	Thread size	Model
0 to 84	0 to 6	0 to 0.6	2"	R1/8	18-015-012
0 to 145	0 to 10	0 to 1	2"	R1/8	18-015-013
0 to 362	0 to 25	0 to 2.5	2"	R1/8	18-015-014

*3) primary scale

Center back connection, black face



Pressure range

(psi) *3)	(bar)	(MPa)	ø	Thread size	Model
0 to 60	0 to 4	0 to 0.4	2"	1/8" NPT	18-015-202
0 to 160	0 to 11	0 to 1.1	2"	1/8" NPT	18-015-204
0 to 300	0 to 20	0 to 2.1	2"	1/8" NPT	18-015-205

*3) primary scale

Service kits

R84 / B84
Elastomer kit



FRLB84-Kit

Dimensions

Dimensions in inches (mm)
 Projection/Third angle

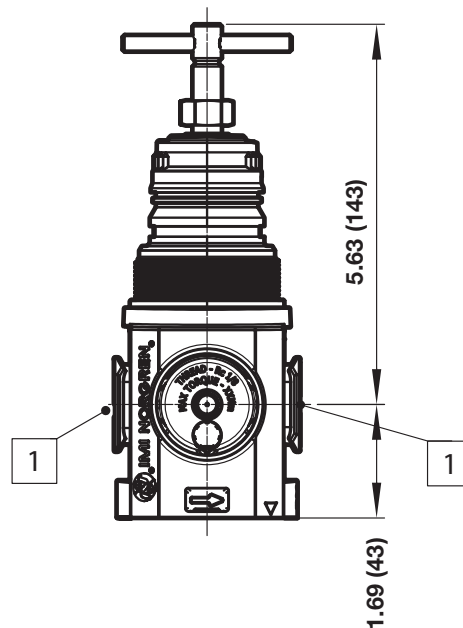
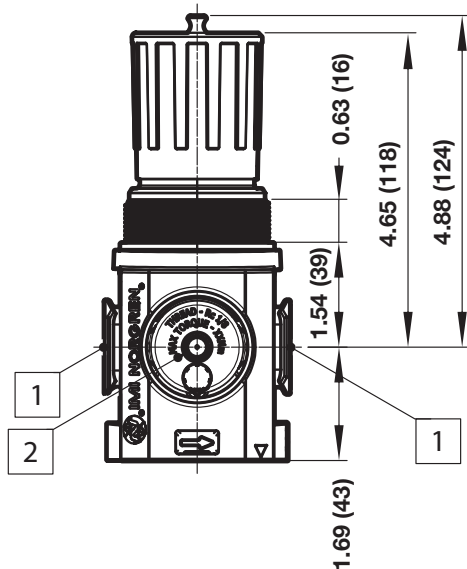
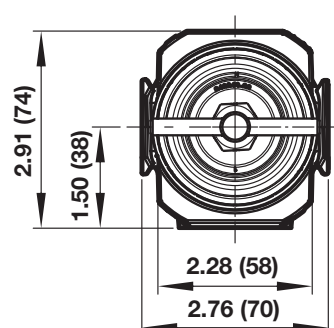
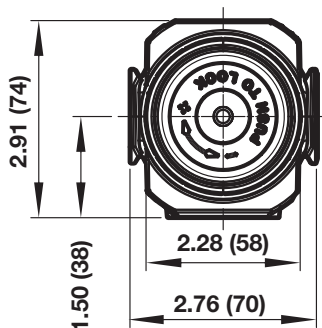

- 1 Main ports 3/8", 1/2" or 3/4"
(ISO G/PTF)
- 2 Gauge Port Rc 1/8 for ISO G and
1/8 PTF for PTF main ports

Accessories

Quikclamp® with wall bracket

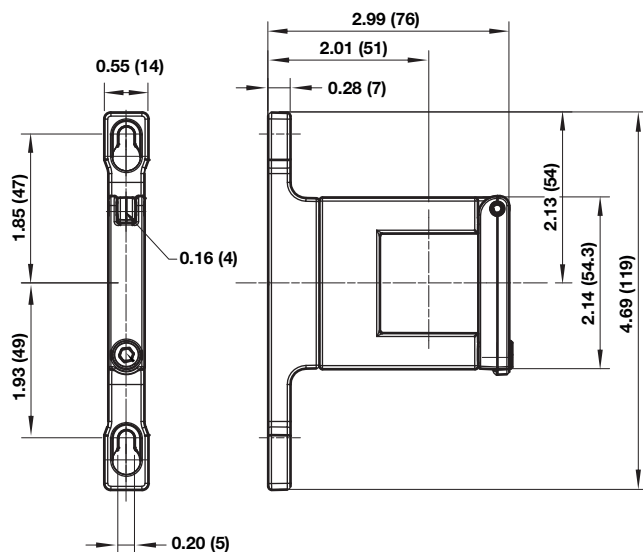

Quikclamp®

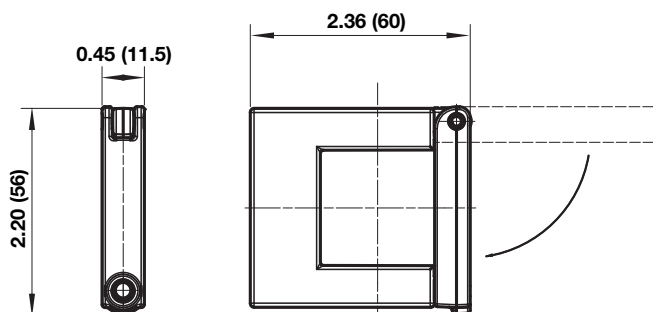

Neck mounting bracket

Panel mounting nut

Dimensions in inches (mm)
Projection/Third angle

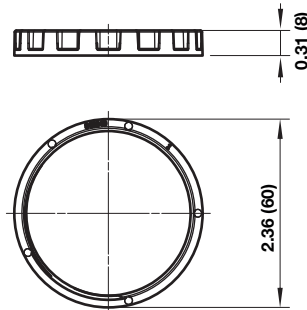
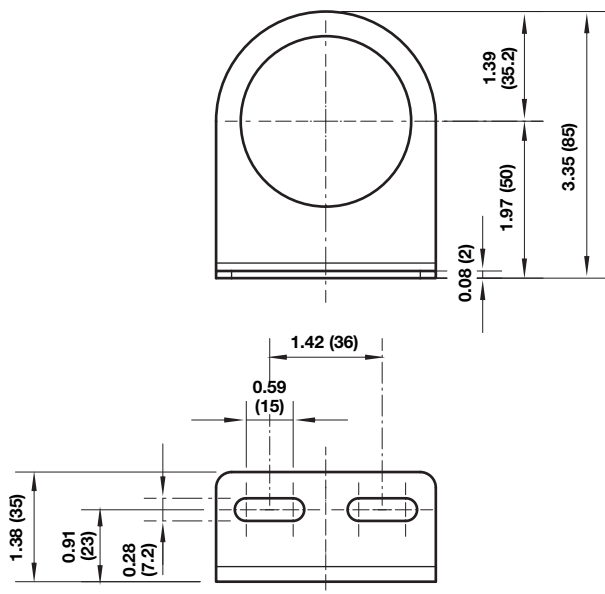

Mounting bracket

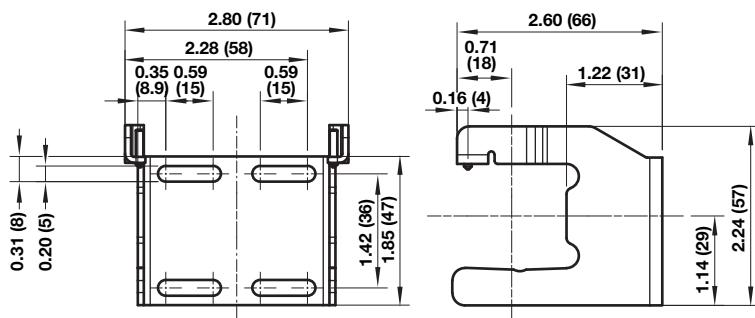

Pressure sensing block

Full flow porting block

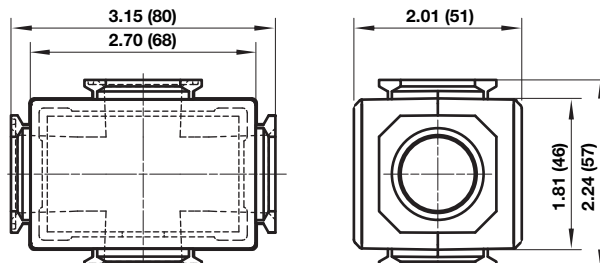
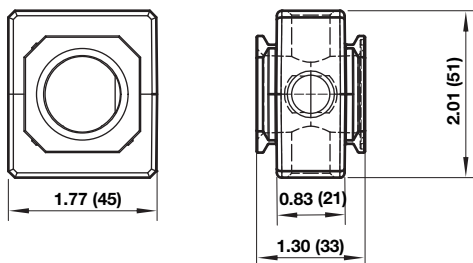

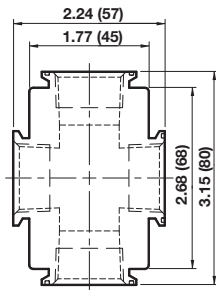
**Full flow vertical
porting block**

**Porting block for
18D pressure switch**

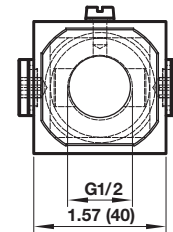
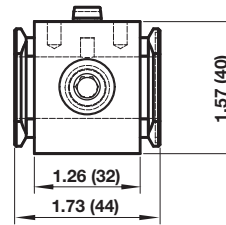
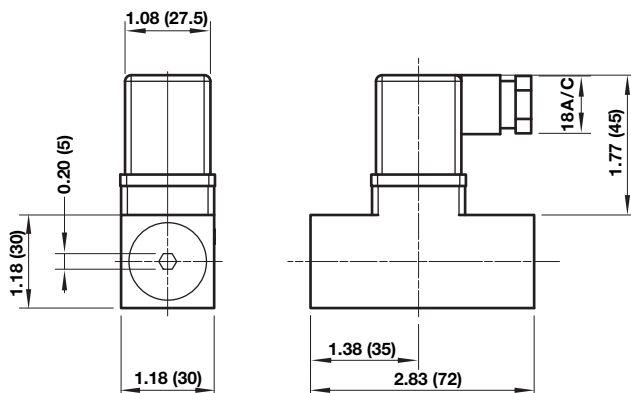
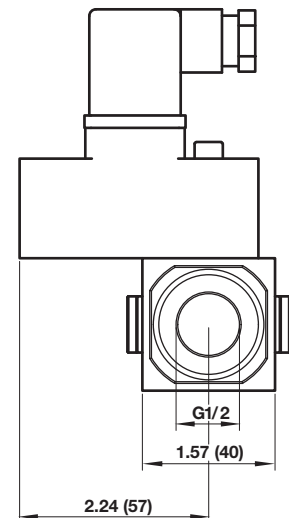
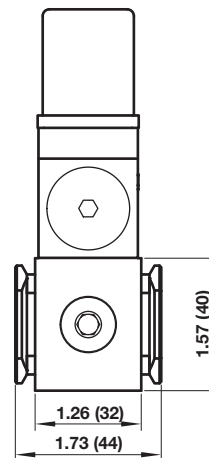
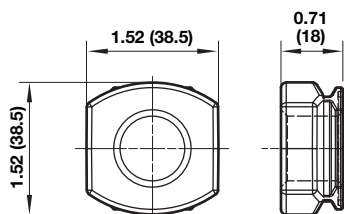
Dimensions in inches (mm)
Projection/Third angle

18D Pressure switch

**18D Porting block and
18D assembled**

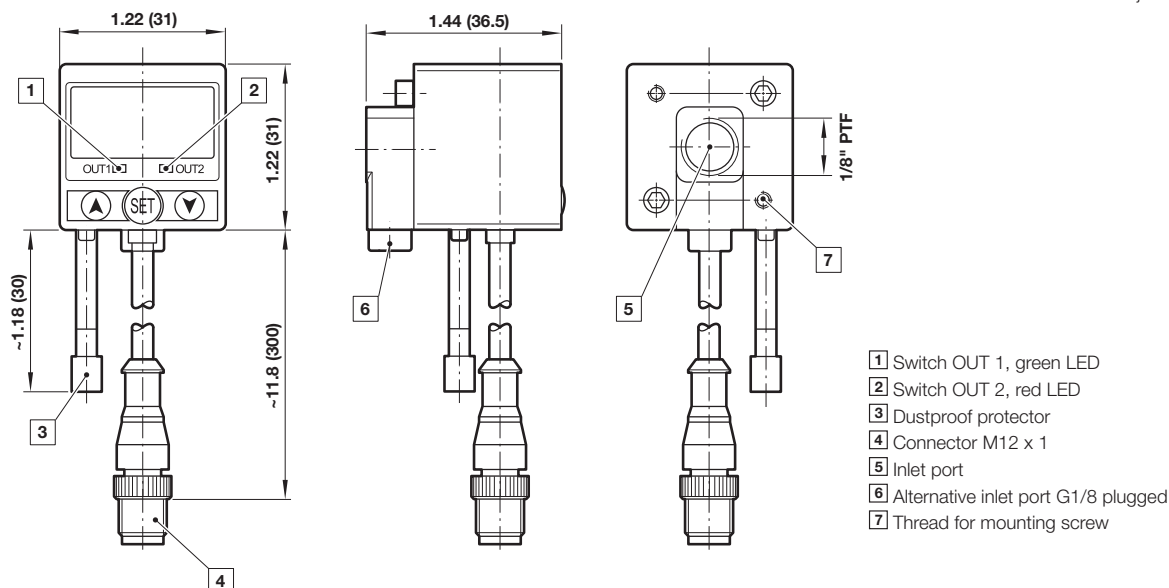
Pipe adaptor

51D Pressure switch - digital

Dimensions in inches (mm)
Projection/Third angle



- 1 Switch OUT 1, green LED
- 2 Switch OUT 2, red LED
- 3 Dustproof protector
- 4 Connector M12 x 1
- 5 Inlet port
- 6 Alternative inlet port G1/8 plugged
- 7 Thread for mounting screw

Warning

Improper selection, misuse, age or malfunction of components used in systems can cause failure in various modes. The system designer is warned to consider the failure modes of all component parts and to provide adequate safeguards to prevent personal injury or damage to equipment or property in the event of such failure modes. System designers and end users are cautioned to consult instruction sheets and specifications available from the factory. The system designer/end user is responsible for verifying that all requirements for the application are met.

Warranty

The products described herein are warranted subject to seller's Standard Terms and Condition of Sale, available at seller's website.

Proposition 65: These products may contain chemicals known to the state of California to cause cancer, or birth defects, or other reproductive harm.